



REQUEST FOR QUOTATION

(For Infrastructure Projects)

Company Name/TIN: _____
Business Address: _____

Date: May 30, 2025
PR No: 2025-05-0271

Please quote your lowest price on the item/s listed below, subject to the terms and conditions stipulated, and submit your quotation duly signed by your representative not later than **June 2, 2025; 09:00 A.M.** in the return envelope to the BAC Secretariat, DSSC, Matti, Digos City, or email to psu@dssc.edu.ph.

TERMS AND CONDITIONS:

- Completion of Works:** 45 calendar days from receipt of Purchase Order.
- Price validity:** 120 calendar days
- Documentary requirements:**
PhilGEPS Reg. Number, Mayor's Permit, PCAB License, SEC/DTI Cert., BIR Cert. of Reg., Bill of Quantities, Detailed Estimates, Omnibus Sworn Statement, & Income/Business Tax Return (For ABCs above P500K)
- The Approved Budget for the Contract for this procurement is, **Php 300,000.00**

RACHEL R. YONTING

Procurement Service Unit Head/BAC Secretariat

Item No.	Qty.	Unit	Item Description	ABC per Item	Unit Cost	Total Cost
1	1	Lot	Improvement of HR Office	300,000.00		
GRAND TOTAL:						

Completion of Works: _____

Price Validity : _____

After having carefully read and accepted your General Conditions, I/We quote you on the item/s at prices noted above. If the space for delivery period, warranty, and price validity are left blank, it means that I/ We concur with the terms and conditions specified by the Davao del Sur State College (DSSC).

Canvasser

Printed Name and Signature

Contact Details:

Landline: _____

Mobile No. _____

E-mail address: _____

Date signed: _____



Name of the Project: IMPROVEMENT OF HR OFFICE
 Location: DAVAO DEL SUR STATE COLLEGE CAMPUS, MATTI, DIGOS CITY
 Project Duration: 45 Calendar Days
 Scope of Work: As per Item Number

BILL OF QUANTITIES

ITEM NO.	ITEM DESCRIPTION	QUANTITY	UNIT	UNIT COST	AMOUNT
A.1	OCCUPATIONAL SAFETY AND HEALTH PROGRAM	1.00	lot		
A.2	MOBILIZATION / DEMOBILIZATION	1.00	lot		
A.3	REMOVAL OF OBSTRUCTION (Office Furnitures and other materials)	1.00	lot		
A.4	TILEWORKS - FLOOR (Ceramic Glazed Tiles)	45.53	sq.m.		
A.5	PAINTING WORKS	163.16	sq.m.		
A.6	CARPENTRY WORKS (3/4" Marine Plywood)	1.00	lot		
A.7	PARTITION (Steel Framed Partition with Glass Panel) -38mm x 1.20mm Square Tube Frame -6mm thk. Marine Pywood Partition -w/ 5mm Clear Glass Panel applied with frosted sticker	4.29	sq.m.		
A.8	OFFICE FURNITURES (Office Tables with Partition & Mobile Pedestal)	7.00	sets		
A.9	ELECTRICAL WORKS	1.00	lot		
				GRAND TOTAL	-

Prepared by:





ISSUE STATUS	REV. NO.	EFFECTIVE DATE	PAGE NO.
01	00	09.01.2022	1 of 1



Name of Project: **IMPROVEMENT OF HR OFFICE**
Location: **DAVAO DEL SUR STATE COLLEGE CAMPUS, MATTI, DIGOS CITY**

SCOPE OF WORK

OTHER GENERAL REQUIREMENT

- Site clearing (existing tables, chairs, cabinet, etc.) and preparation.
- Removal of existing projector bracket attached at ceiling.
- Mobilization/Demobilization.

CONSTRUCTION SAFETY AND HEALTH

- Ensure compliance with DOLE criteria for construction safety and health.
- Ensure that all workers to always wear PPEs. (Safety helmets, shoes, gloves, vest, and harness).

CARPENTRY WORKS

- Fabrication of scaffoldings for painting works and wall mounted cabinet installation.
- Use 19mm thick or ¾" marine plywood for wall mounted cabinet works.
- Use C-type aluminum cabinet door handle
- Use soft close hinges for cabinet doors.

STEEL WORKS

- Fabrication of office partition with steel framing. **(Refer to Plan)**

TILING WORKS

- Install 60x60cm glazed Tile for floor. **(Refer to Plan)**
- Use Tile Adhesive as binder.
- Use Tile Grout (same color of tiles) for sealing of all connections/joints.

PAINTING WORKS

MASONRY

- Use sandpaper to remove peeled paint. (if necessary)
- If existing wall paint is in good condition, use 240 or 320 grit sandpaper for light sanding before the application of topcoat.
- Apply skim coat (white powder). (if necessary)
- Fill all imperfections, knots, cracks and apply paint on all wooden doors and door jambs.
- Apply concrete primer. (if necessary)
- Apply minimum of two (2) coats of semi-gloss paint for topcoat.

EXISTING WOOD SHELVES (to match the design of the table w/ partition set)

- Repainting of existing 2-unit shelves with haspe/wood design. *(Paint finish may vary depending on the actual design of the table w/ partition set).*
- Apply wood primer. (if necessary)
- Apply wood putty for wooden surfaces.
- Use sandpaper for light sanding before the application of topcoat.
- Apply minimum of two (2) coats of quick dry enamel paint for topcoat.





ISSUE STATUS	REV. NO.	EFFECTIVE DATE	PAGE NO.
01	00	09.01.2022	1 of 1



PARTITION BOARD

- Use sandpaper for light sanding before the application of topcoat.
- Apply wood primer.
- Apply wood putty for wooden surfaces.
- Apply minimum of two (2) coats of quick dry enamel paint for topcoat.

PARTITION FRAME

- Apply Epoxy Primer for steel surfaces.
- Apply minimum of two (2) coats of quick dry enamel paint for topcoat.

ELECTRICAL WORKS

- Additional convenience outlet. (**Refer to Electrical Plan**)

Prepared by:

ENGR. HARVEY T. PIAMONTE
PDO – CIVIL ENGINEER

Checked/ Reviewed by:

ENGR. BON ANDREY L. ARMAMENTO
PDO III

Checked/ Reviewed by:

ENGR. CLARA A. ACEBES
PPDME - DIRECTOR

Approved by:

AUGIE F. FUENTES, PhD.
COLLEGE PRESIDENT



www.dssc.edu.ph



@DSSCOfficial



president@dssc.edu.ph









COLLEGE LOGO		PROJECT TITLE	PREPARED BY:	CHECKED AND REVIEWED BY:	RECOMMENDING APPROVAL:	APPROVED BY:	SHEET CONTENTS	BET NO.	SHEET NO.
		IMPROVEMENT OF MR OFFICE	ENGR. HANRY P. TROBANTE FOOT-CYCL. ENGINEER	ENGR. RON ALBERT L. ANAQUENTO MD II	ENGR. CLARA A. ACERES PRINC. - ARCHITECT	AS INDICATED		A3	3
PROJECT LOCATION		DISC - 8005 CAMPUS, MATTI, DIGOS CITY, DAVAO DEL SUR							

1 FLOOR PLAN

Scale 1:50m.

FLOOR FINISH SCHEDULE





MODEL	DESCRIPTION	REMARKS
	600mm x 600mm CERAMIC GLAZED TILES WITH WHITE TILE GROUT	THE TILE UNIT SPECIFIED IS SUBJECT TO AVAILABILITY AND MAY VARY BASED ON STOCK CONDITIONS
	OFFICE TABLE WITH PARTITION AND MOVABLE PEDESTAL (1200 L x 800 W x 875 H)	THE TABLE UNIT SPECIFIED IS SUBJECT TO AVAILABILITY AND MAY VARY BASED ON STOCK CONDITIONS

2 WALL MOUNTED CABINET DETAIL

Scale 1:20m.



1 **PARTITION DETAIL**
Scale 1:30m.

COLLEGE LOGO	PROJECT TITLE	PREPARED BY	CHECKED AND INITIALED BY	RECOMMENDING APPROVAL	APPROVED BY	SHEET NO.	SHEET NO.
	IMPROVEMENT OF HR OFFICE	 ENGR. HARRIET T. PANGNATE ESQ - CIVIL ENGINEER	 ENGR. BON ARREY L. ARMANDITO ESQ -	 ENGR. CLARA A. ACOBES PYSC - DIRECTOR	 AUGUSTO L. ACOBES, PhD COLLEGE PRESIDENT	A4	4
	PROJECT LOCATION					A4	5
	FINISC - DIOS CAMPUS, NATTI, DIOS CITY, DAVAO DEL SUR						



ELECTRICAL LEGEND:

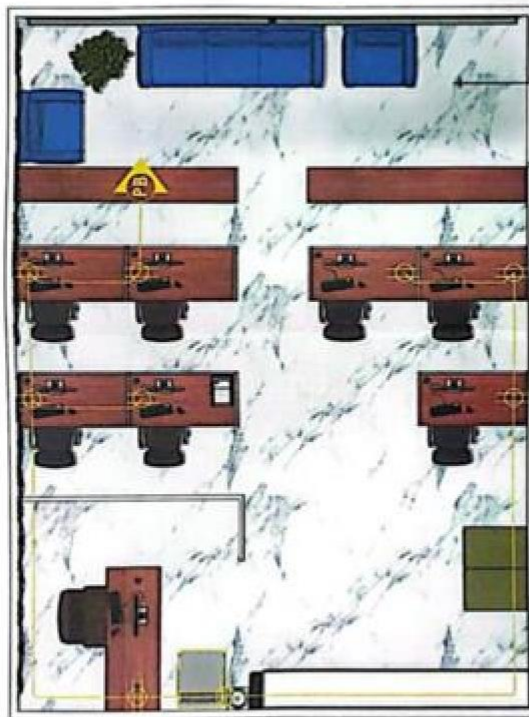

1 POWER LAYOUT
Scale 1:50m.

COLLEGE LOGO	PROJECT TITLE	PREPARED BY	CHECKED AND REVIEWED BY	RECOMMENDING APPROVAL	APPROVED BY	SHEET CONTENTS	SET NO.	SHEET NO.
	IMPROVEMENT OF HR OFFICE	ENGR. JIMMY L. JAMES/2015	ENGR. JAMES C. VASILDAG	ENGR. CLARA A. ACERES	AUSIE L. VIENTES, PhD	AS INDICATED	E1	1
	PROJECT LOCATION:	ENGR. JIMMY L. JAMES/2015	ELECTRICAL PLANNING IN-CHARGE	PPDME - DIRECTOR	COLLEGE ENGINEER		E1	1